



## Kestrel Rack Mount Chassis A-Series

One neat package for PC and custom interfaces!

### A beautiful instant upgrade!!

Your Hp1000 application moves smoothly into the modern world of Microsoft Windows NT /Windows 2000, preserving all the signals needed to drive your custom interface. The Kestrel Rack Mount Chassis houses the host PC, disks, tapes, CD-ROM with as many as 9 HP1000

A-series I/O cards in one FCC and CE certifiable package!

Migration problems? None! You chose the quick, sure, inexpensive solution when you chose the Kestrel executing RTE-A as a Windows NT application. Complete your migration gracefully with Strobe's Kestrel Rack Mount Chassis (KRMC).

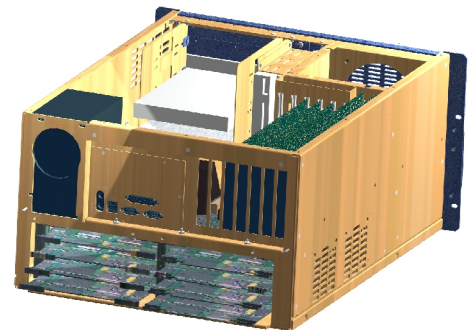
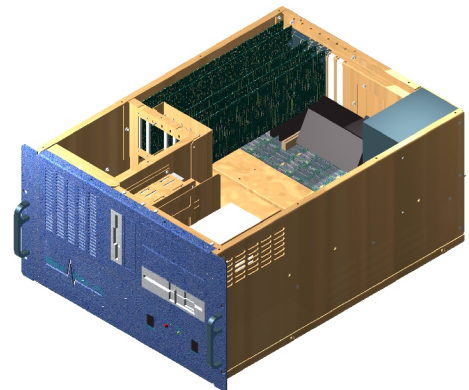

### Morphing the HP 1000 into the 21st century!

MANY GOOD YEARS OF LIFE LEFT IN THAT APPLICATION OF YOURS

Strobe Data's Kestrel, a faster, more flexible, modern HP 1000 gives you the commodity priced peripherals you count on in today's world. An adjustable CPU clock provides just that extra bit of compatibility needed to ensure the continued integrity of your real time process through its custom interface.

# Kestrel Rack Mount Chassis

## Specifications

### Physical

<b>Construction:</b>	Heavy-duty aluminum .100" thick
<b>Indicators:</b>	LED indicates power On/Off and hard disk drive activity.
<b>Disk Drives</b>	Space for three 5.25" drives and two 3.5 drives
<b>Dimensions</b>	17" W x 10.5" H x 23" L
<b>Weight</b>	Estimated at 65 lbs
<b>Cooling</b>	3 Internal fans 2 - 2850 RPM 51.1 CFM 1 - 2100 RPM 72.4 CFM
<b>Controls</b>	Reset switch. On /Off switch on front panel.

### Power Supply

#### 450 ATX

<b>Output Rating:</b>	450 Watts
<b>Input Voltage:</b>	90-135VAC, 180-270 VAC
<b>Frequency:</b>	47-63HZ
<b>Output Voltage:</b>	+5VDC@50A,+12VDC@18A, -5VDC@2A,+3.3VDC@40A, +5VSB@2A,+5 &+3.3<300W
<b>MTBF:</b>	100,000 hours
<b>Safety:</b>	UL,ULC,CE
<b>EMI:</b>	FCC-B, CE

### Environmental

#### Operating Conditions

<b>Temperature</b>	5 to 50 C (41 to 122 F)
--------------------	-------------------------

### Backplanes

<b>HP 1000</b>	10-Slot (9 useable)
<b>PC</b>	ATX

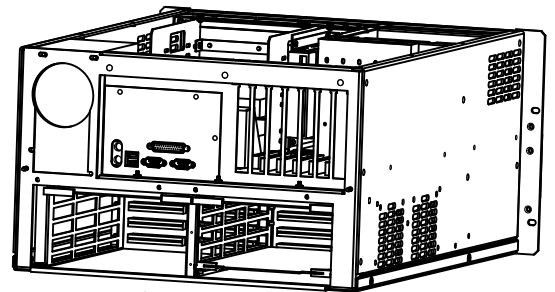
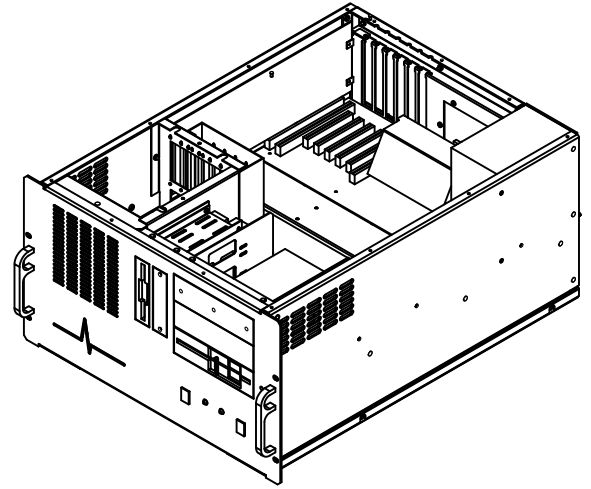

HP 1000 Slots - 10

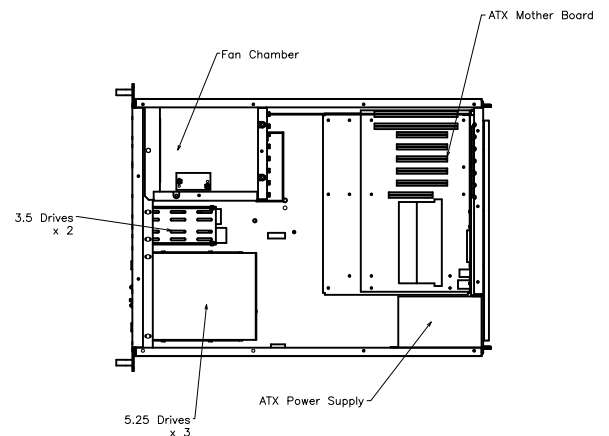

**Strobe Data Inc.**

14940 NE 95th Street Suite B Redmond, WA. 98052

Phone: (425) 861-4940 Fax: (425) 861-4295 www.strobedata.com

HP1000 is a trademark of Hewlett Packard Corporation  
RTE is a trademark of Hewlett Packard Corporation  
Kestrel co-processor is a trademark of Strobe Data Inc.  
Rack Mount Kestrel Chassis is a trademark of Strobe Data Inc